

# SWS200

## Wall Mounted Security iPad Stand

Have peace of mind knowing your business' investment is safe with the Kanto SWS200 wall mount security iPad stand. The Kanto SWS200 is specifically designed to house the newest 10.2" iPad. The full motion design makes it easy for you to adjust the display to the best viewing angle. This sleek stand comes in your choice of black or white to match your space.



## FEATURES & SPECIFICATIONS

- Securely fits 10.2" iPad models
- 90° rotation for portrait and landscape screen orientation
- Extends up to 7.9" (19.9 cm) from the wall
- Full-motion design provides unlimited viewing angles
- +65°/-65° of tilt for the best viewing angle
- 90° of swivel left or right for comfortable viewing
- Included velcro straps for cable management
- Installs into a single stud
- Cutouts for use of home button and front camera
- 2 keys provided for tablet enclosure
- Five year manufacturer's warranty
- Shipping box weight: 5.1 lb (2.3 kg)
- Shipping box dimensions: 15" x 8.7" x 4.7" (38 x 22 x 12 cm)
- Product weight: 4 lb (1.8 kg)
- UPC: 800152720838 - SWS200 (Black)
- UPC: 800152720845 - SWS200W (White)

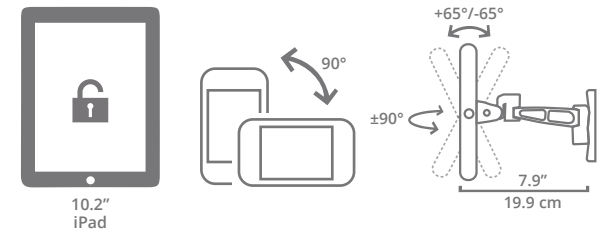

## TECHNICAL ILLUSTRATIONS



### LOCKING ENCLOSURE

You can have peace of mind knowing your investment is safely locked. When you're ready to remove the iPad, you can easily do so with one of the two included locking keys.



### WALL-MOUNTING

Bolting the stand to the wall provides you with extra security from theft.

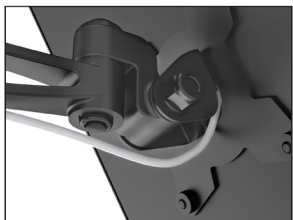

### CABLE MANAGEMENT

Make sure your device is always charged and the cable is snag free by keeping the cable within the arm of the stand.



### ADJUSTABLE

The fully-articulating arm allows you to swivel the iPad 90 degrees right or left. You can also tilt and rotate the screen to the most optimal viewing position.

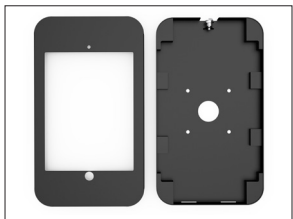

### BUTTON AND CAMERA CUT-OUTS

Cut-outs allow for unobstructed use of the iPad.

